

ATTIC PLAN GENERAL NOTES

- DRAFT STOPS WALLS AS SHOWN ON THE PLAN SHALL BE 3/8" TYPE 2-M PARTICLE BOARD (OR 3/8" PLYWOOD OR 1/2" GYPSUM BOARD) ATTACH ON ONE SIDE OF THE TRUSS/STUD WALL AS INDICATED. PROVIDE ADEQUATE SUPPORT BETWEEN TRUSS WEB MEMBERS. PROVIDE BLOCKING AT ENDS OF ALL PANELS. DRAFT STOP BARRIER SHALL EXTEND FROM CEILING FRAMING BELOW TO ROOF DECK ABOVE, AND SHALL EXTEND INTO AND CLOSE OFF SOFFITS.
- DRAFT STOP DOORS AS INDICATED ON THIS PLAN SHALL CONSIST OF THE FOLLOWING:
 - DOOR SHALL BE 1 3/8" T. HOLLOW CORE WOOD WITH THE LARGEST HEIGHT AND WIDTH POSSIBLE FOR EACH LOCATION TO A MAXIMUM SIZE OF 2'-8" WIDE x 6'-8" HIGH.
 - PROVIDE A RABBETTED 2x4 WOOD FRAME WITH SMOKE GASKETING.
 - DOOR HARDWARE SHALL CONSIST OF A PAIR OF SPRING LOADED HINGES AND A PASSAGE LOCK SET.

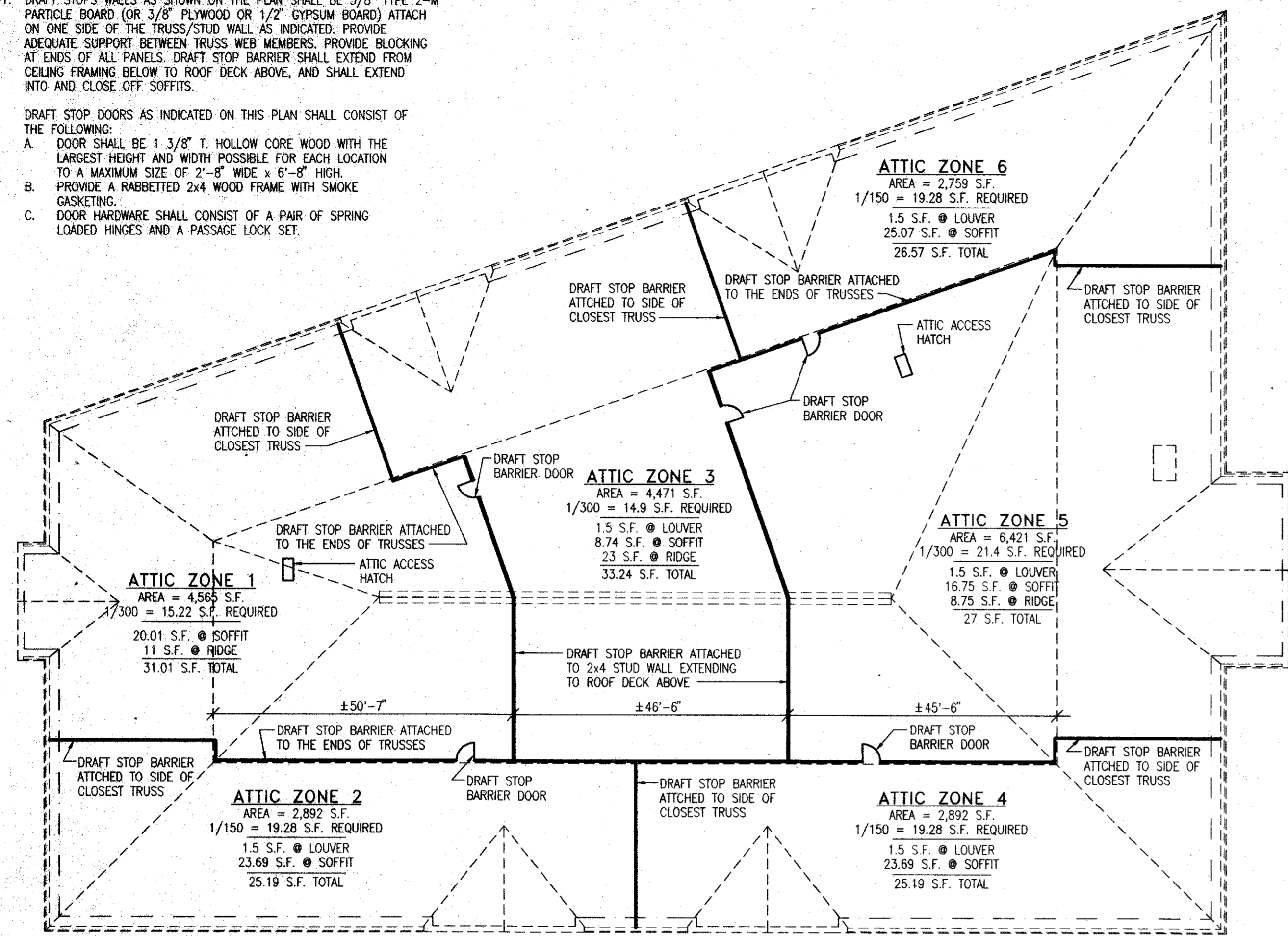

ATTIC PLAN
SCALE: 1/16" = 1'-0"

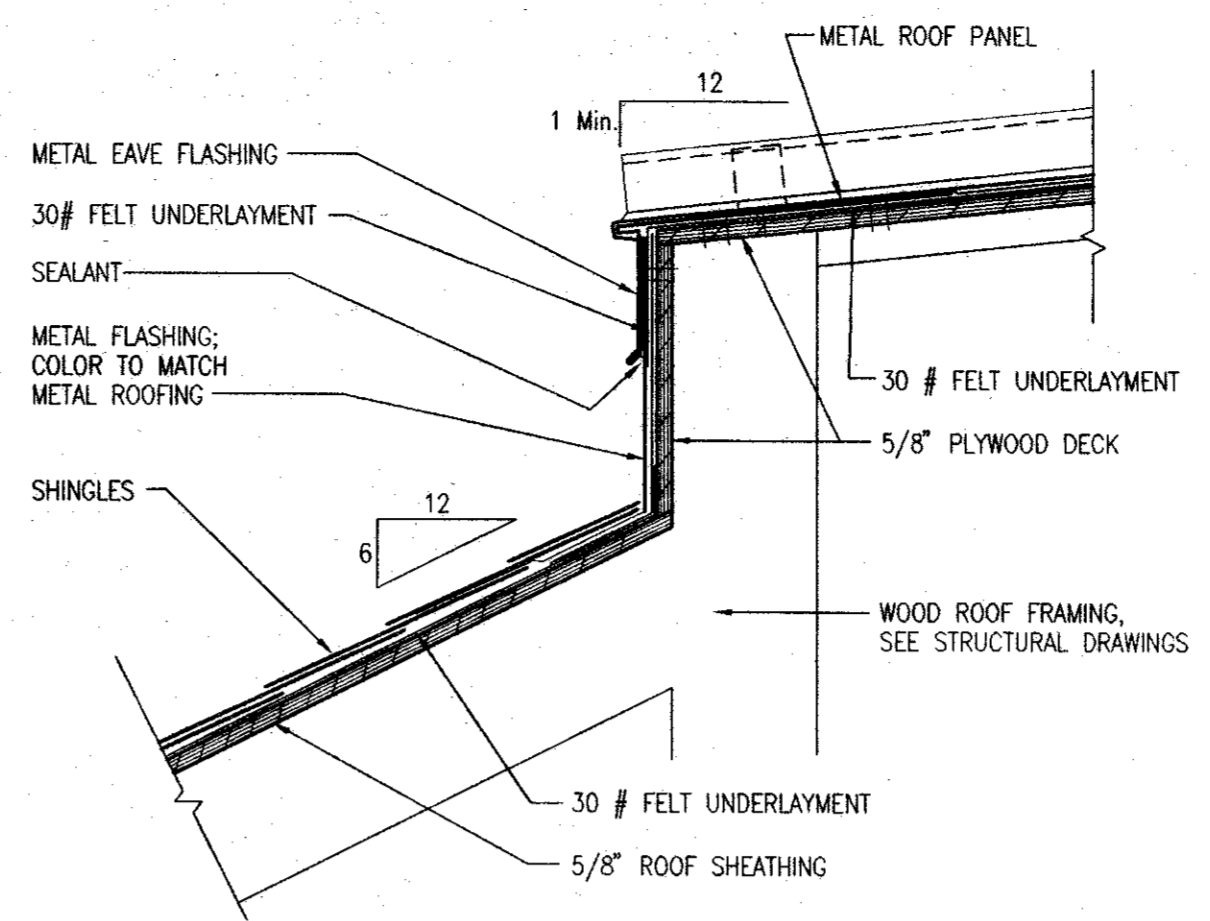

ROOF TRANSITION DETAIL
SCALE: 1 1/2" = 1'-0"
D15
A2.4

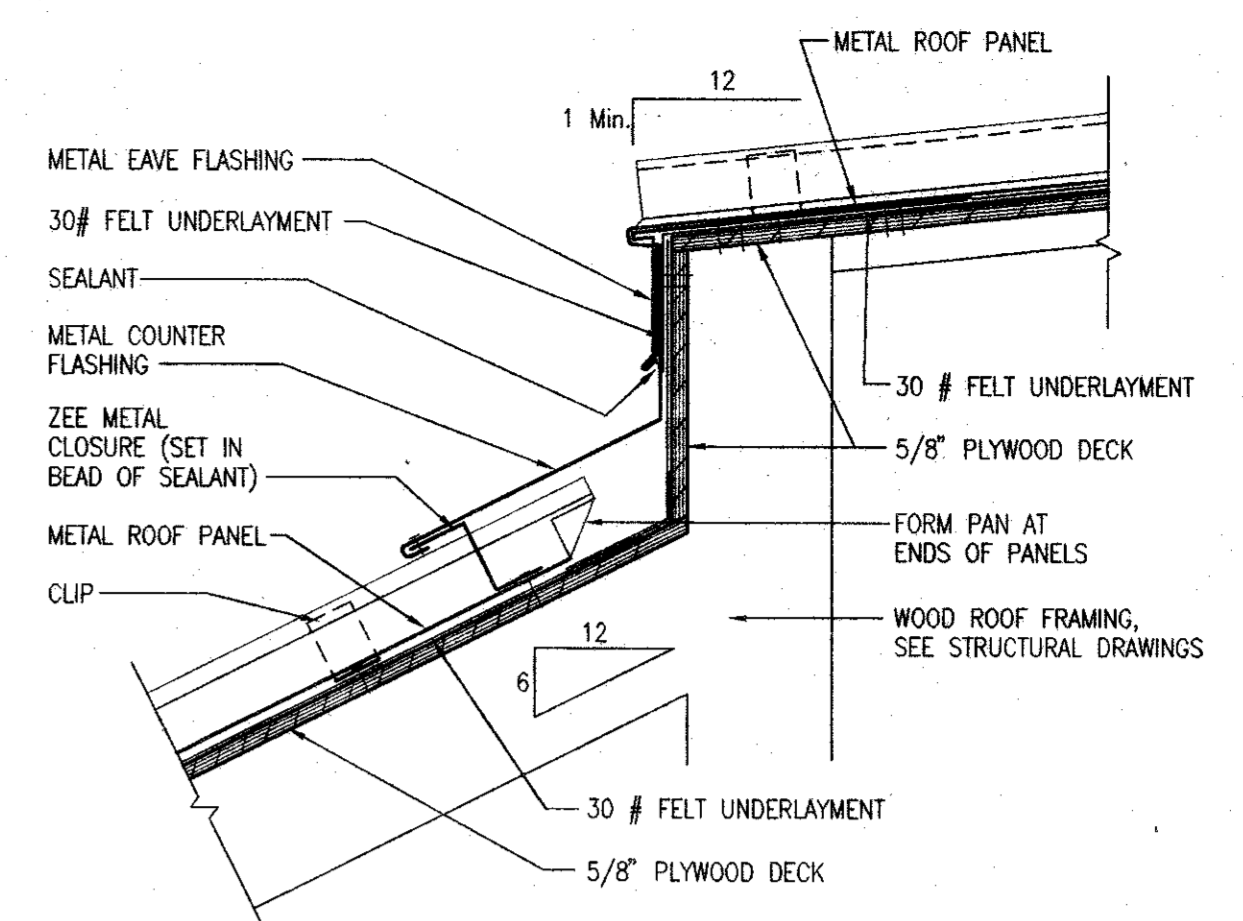

ALTERNATE #1 ROOF TRANSITION DETAIL
SCALE: 1 1/2" = 1'-0"
D14
A2.4

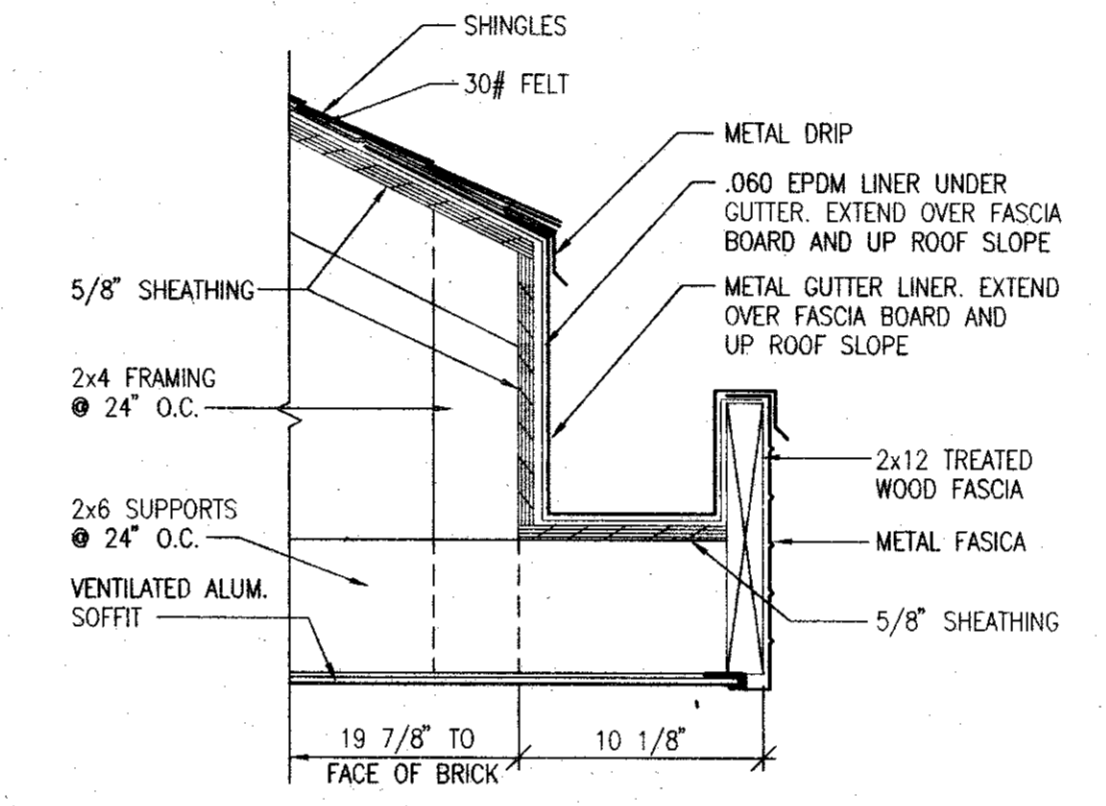

GUTTER DETAIL
SCALE: 1 1/2" = 1'-0"
D16
A2.4

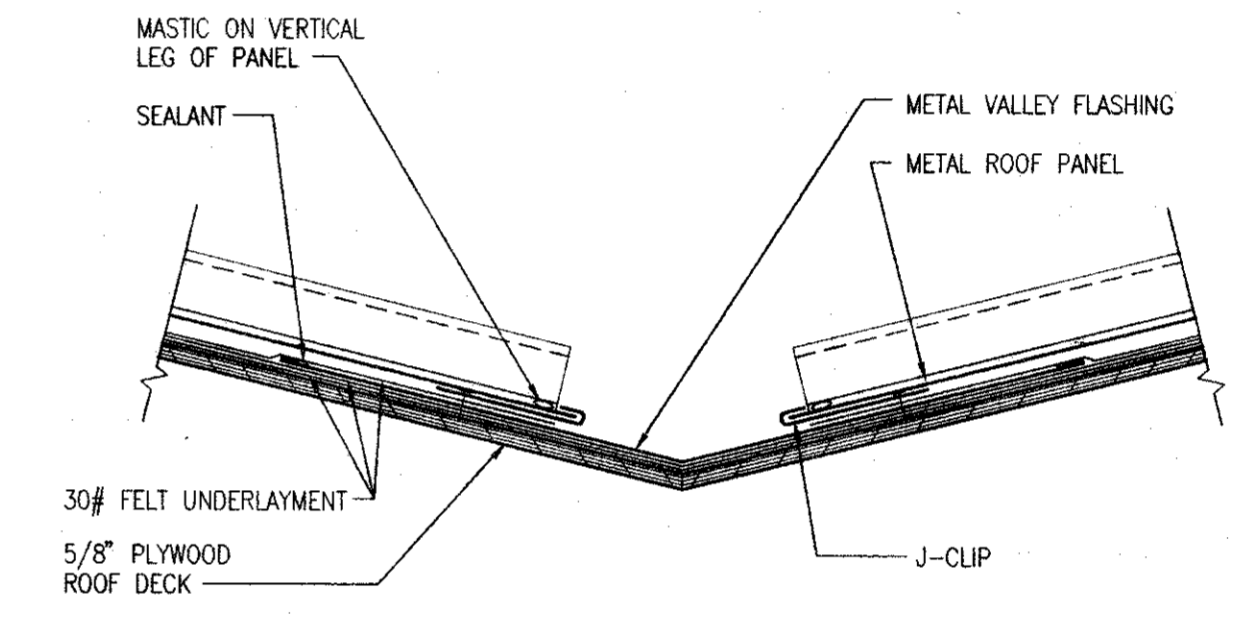

TYPICAL VALLEY DETAIL
SCALE: 1 1/2" = 1'-0"
D13
A2.4

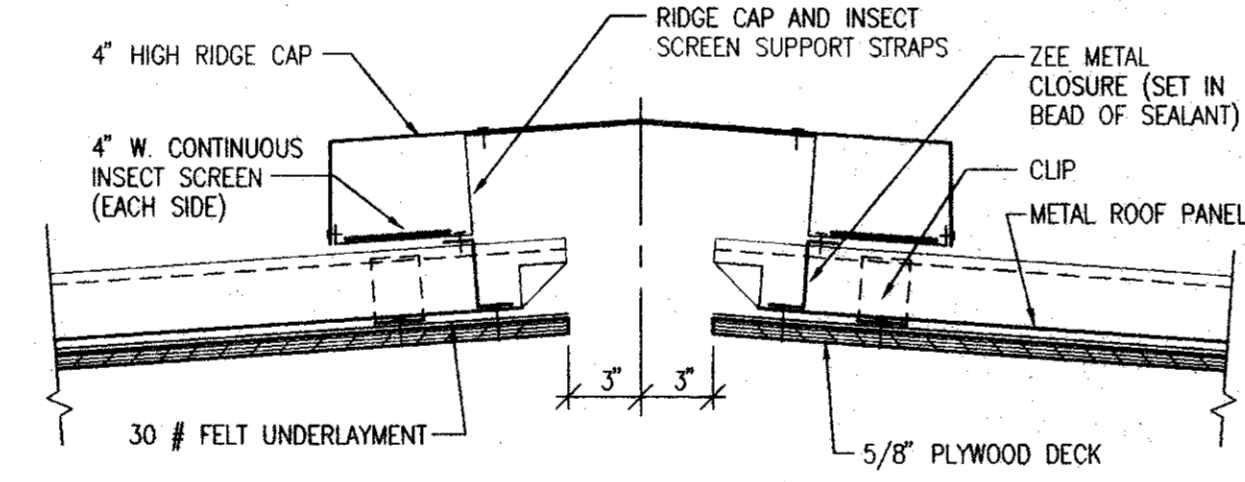

RIDGE VENT DETAIL
SCALE: 1 1/2" = 1'-0"
D110
A2.4

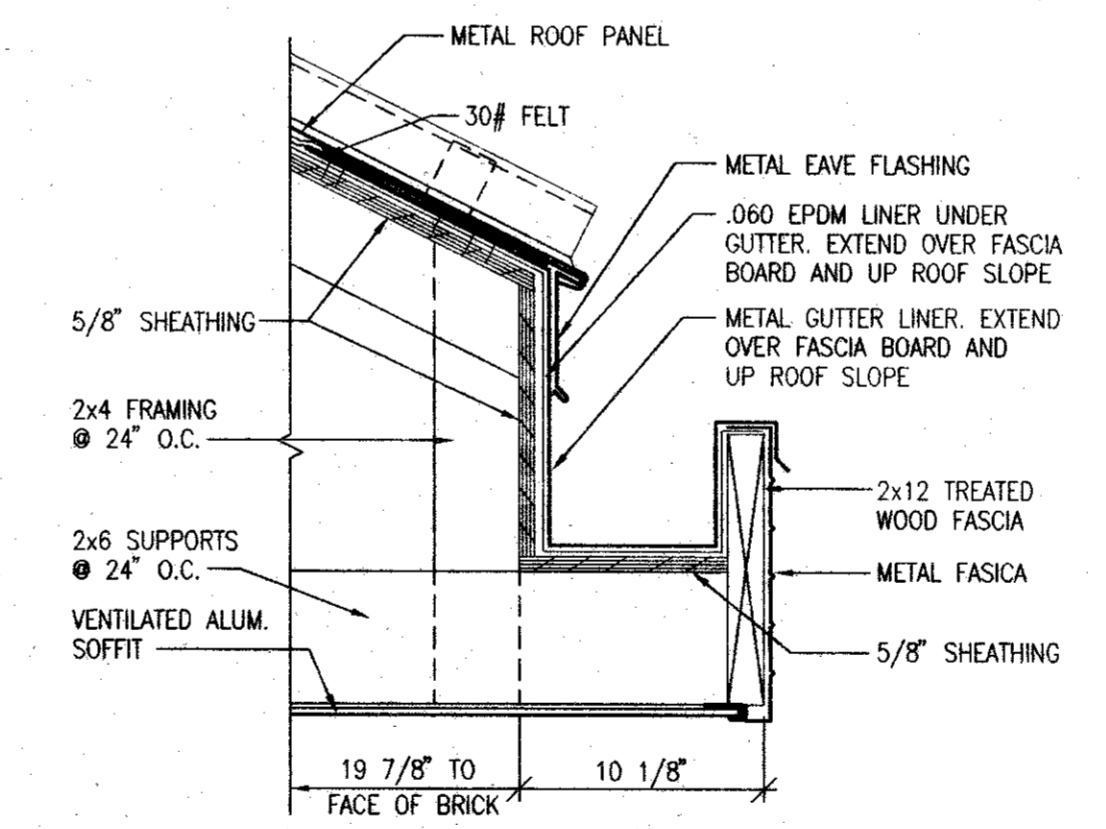

GUTTER DETAIL
SCALE: 1 1/2" = 1'-0"
D17
A2.4

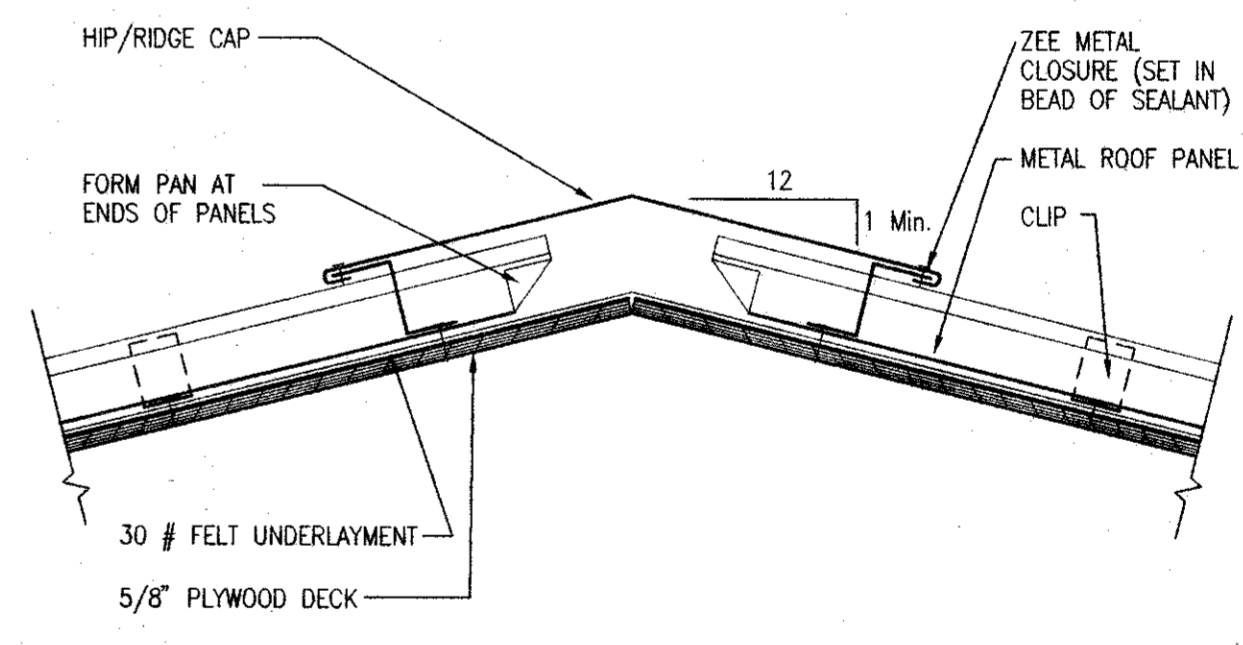

TYPICAL HIP & RIDGE DETAIL
SCALE: 1 1/2" = 1'-0"
D12
A2.4

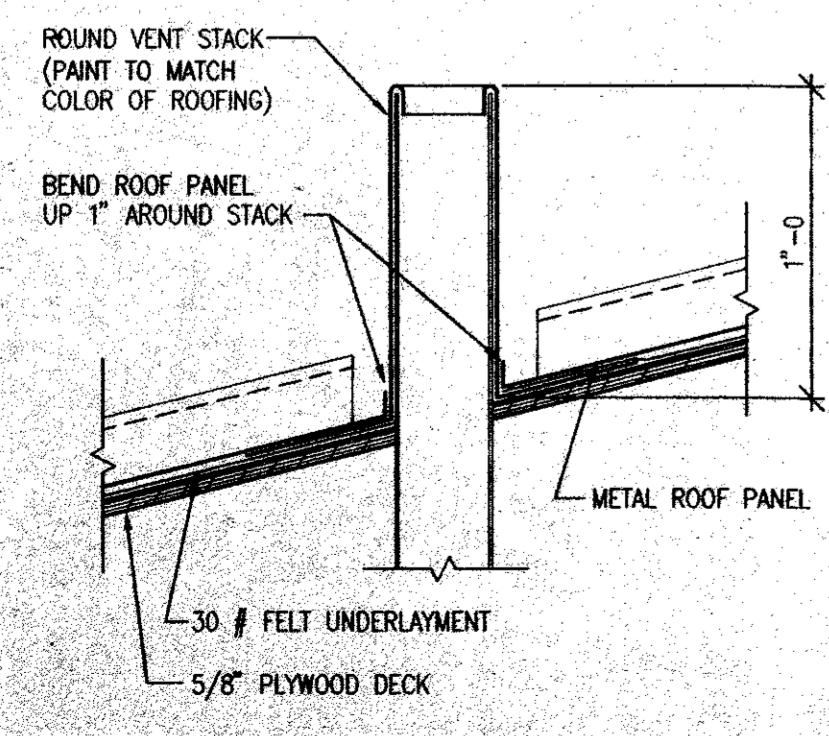

VENT STACK DETAIL
SCALE: 1 1/2" = 1'-0"
D111
A2.4

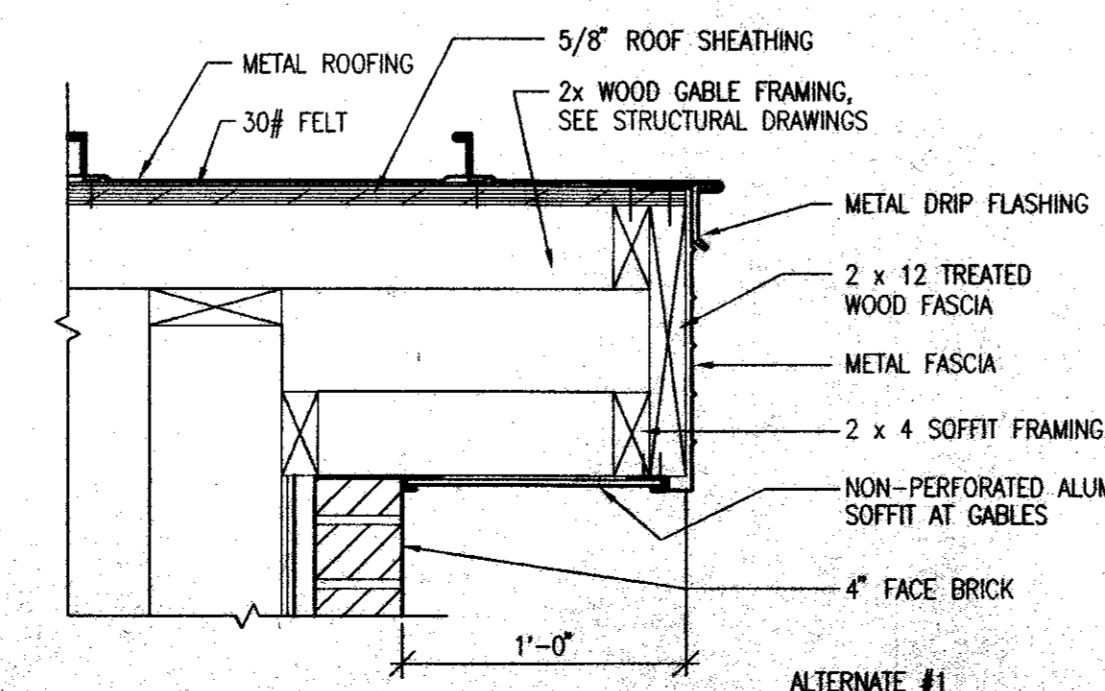

GABLE EAVE DETAIL
SCALE: 1 1/2" = 1'-0"
D19
A2.4

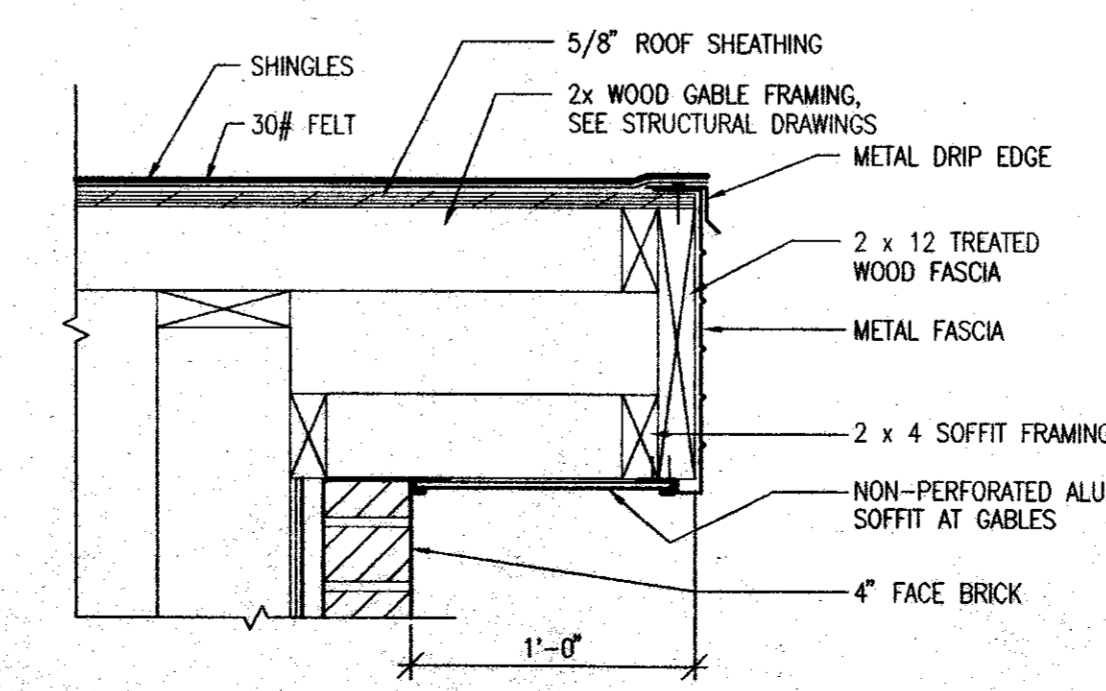

GABLE EAVE DETAIL
SCALE: 1 1/2" = 1'-0"
D18
A2.4

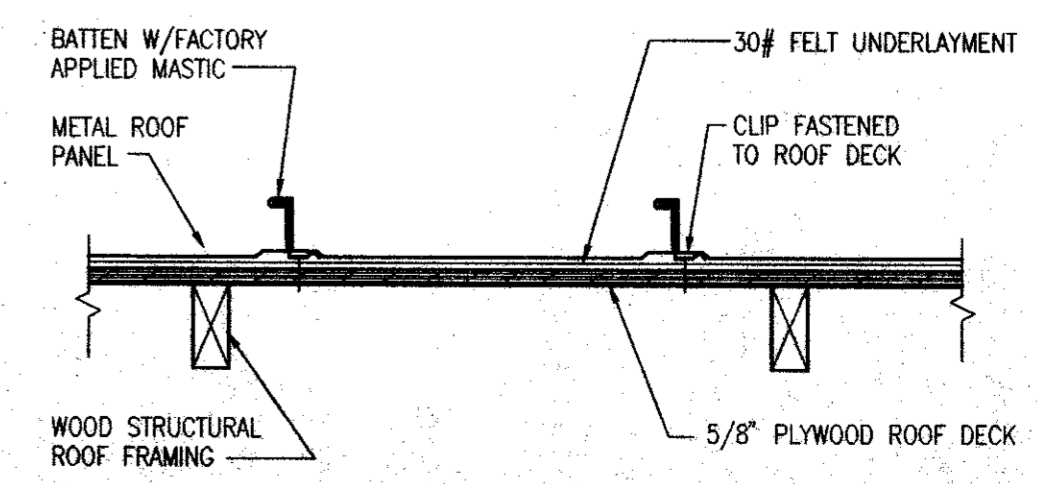

TYPICAL ROOF SECTION
SCALE: 1 1/2" = 1'-0"
D11
A2.4

The InterDesign Group, Inc.
141 East Ohio Street
Indianapolis, Indiana 46204
317/263-9655 Fax 317/263-9644

Goshen Public Library
Addition & Renovation
601 South Fifth Street Goshen, Indiana

Roof Details and Attic Plan

Mark	Revision



Dwn By **JRF** Chkd By **CSM**

Date **August 19, 1993**

These drawings are the property of the Architect and are not to be reused or reproduced without his written permission.

Project Number **921030**

Sheet Number

A 2.4

The InterDesign Group
Total Architectural Development